

CILINDRI DIN ISO 15552 - EASY LINE
DIN ISO 15552 CYLINDERS - EASY LINE

Versioni disponibili - Available versions

CDE..EL - CDEM..EL - CDEP..EL - CDEMP..EL
CDEA..EL - CDEMA..EL - CDEAP..EL - CDEMAP..EL



Cilindri a norma ISO15552
Nuovo design interamente studiato da Cy.Pag.
Rapporto qualità / prezzo ottimizzato
Esecuzione magnetica e non, ammortizzata e non

ISO 15552 cylinders
New design fully conceived by Cy.Pag.
Value for money optimized
Magnetic and non-magnetic version, cushioned and non-cushioned

Informazioni Tecniche
Technical Information

Testate <i>Covers</i>	Alluminio pressofuso verniciato <i>Painted die-casted aluminium</i>
Tubo <i>Tube</i>	Alluminio anodizzato <i>Anodized aluminium</i>
Pistone <i>Piston</i>	NBR (monoblocco) <i>NBR (integral)</i>
Tenuta stelo <i>Rod seal</i>	Poliuretano <i>Polyurethane</i>
Tenuta statiche <i>Static seals</i>	NBR <i>NBR</i>
Stelo <i>Piston rod</i>	Acciaio cromato <i>Chromium coated steel</i>
Tiranti <i>Tie rods</i>	Acciaio zincato <i>Zinc coated steel</i>
Pressione MAX <i>MAX pressure</i>	10 bar
Temperatura di impiego <i>Temperature</i>	-20°C +80°C con aria secca <i>-20°C +80°C with dry air</i>
Fluido <i>Working fluid</i>	Aria compressa filtrata e lubrificata e non <i>Filtered and lubricated or not compressed air</i>

Corse standard
Standard strokes

Ø (mm)	Corse standard (mm) Standard strokes (mm)
32	10-25-40-50-80-100-125-160-200-250-300-320-400-500
40	10-25-40-50-80-100-125-160-200-250-300-320-400-500
50	10-25-40-50-80-100-125-160-200-250-300-320-400-500
63	10-25-40-50-80-100-125-160-200-250-300-320-400-500
80	10-25-40-50-80-100-125-160-200-250-300-320-400-500
100	10-25-40-50-80-100-125-160-200-250-300-320-400-500
125	10-25-40-50-80-100-125-160-200-250-300-320-400-500
DOPPIO EFFETTO DOUBLE ACTING	

Accessori
Accessories

Ømm	Cerniera femmina Female hinge	Cerniera maschio Male hinge	Flangia Flange	Cerniera snodata Male hinge w/spherical bearing	Piedino basso Low-rise pedestal	Perno per cern. femmina Pivot for female hinge	Articolazione a squadra Square Joint	Forcella Clevis	Testa a snodo Rod end	Dado asta Piston rod nut
32	CERF32X	CERM32X	AFP32X	CERMT32X	AF32X	PERC32X	ART32X	FORM10ISO	TSNDM10X1.25	ANA25
40	CERF40X	CERM40X	AFP40X	CERMT40X	AF40X	PERC40X	ART40X	FORM12ISO	TSNDM12X1.25	ANA40B
50	CERF50X	CERM50X	AFP50X	CERMT50X	AF50X	PERC50X	ART50X	FORM16ISO	TSNDM12X1.25	ANA40B
63	CERF63X	CERM63X	AFP63X	CERMT63X	AF63X	PERC63X	ART63X	FORM16ISO	TSNDM16X1.5	ANA50B
80	CERF80X	CERM80X	AFP80X	CERMT80X	AF80X	PERC80X	ART80X	FORM20ISO	TSNDM20X1.5	ANA80100
100	CERF100X	CERM100X	AFP100X	CERMT100X	AF100X	PERC100X	ART100X	FORM20ISO	TSNDM20X1.5	ANA80100
125	CERF125X	CERM125X	AFP125X	CERMT125X	AF125X	PERC125X	ART125X	FORM27ISO	TSNDM27X2	ANA125X
	pag. 121	pag. 121	pag. 121	pag. 123	pag. 122	pag. 123	pag. 124	pag. 120	pag. 120	pag. 119

CDEØ/...EL

CDEMØ/...EL

CDEAØ/...EL

CDEMAØ/...EL

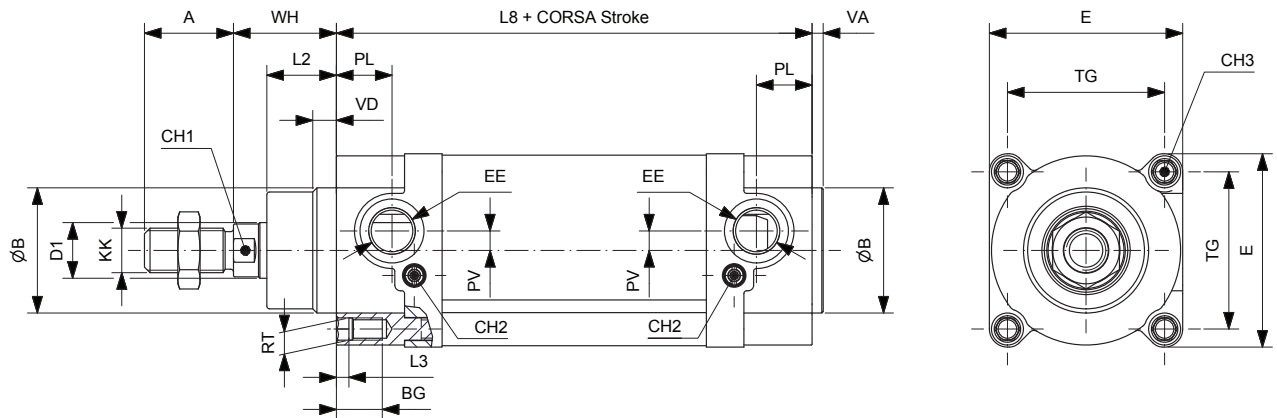

DIMENSIONI
DIMENSIONS

Ømm	ØD1	KK	A	ØB	VD	VA	L2	RT	BG	L3	TG	EE	PL	PV	WH	L8	E	CH1	CH2	CH3
32	12	M10x1.25	22	30	8	4	18	M6	16.5	5	32.5	1/8"G	12.5	-	26	94	44	10	2	6
40	16	M12x1.25	24	35	12	4	22	M6	16.5	5	38	1/4"G	14	-	30	105	51	13	2.5	6
50	20	M16x1.5	32	40	10.5	4	25.5	M8	16.5	4.5	46.5	1/4"G	14	-	37	106	59.5	17	2.5	8
63	20	M16x1.5	32	45	8.5	4	25	M8	16.5	4.5	56.5	3/8"G	20	7	37	121	69.5	17	2.5	8
80	25	M20x1.5	40	45	10	4	35	M10	17	-	72	3/8"G	18.5	6.5	46	128	87	22	4	-
100	25	M20x1.5	40	55	12.5	4	38	M10	17	-	89	1/2"G	20	12	51	138	106.5	22	4	-

FORZE DI TRAZIONE E SPINTA (6 BAR)
TRACTION AND THRUST FORCES (6 BAR)

Ø mm	FORZA DI SPINTA (N) THRUST FORCE (N)	FORZA DI TRAZIONE (N) TRACTION FORCE (N)
32	458	394
40	716	601
50	1180	939
63	1775	1596
80	2863	2583
100	4474	4194

DOPPIO EFFETTO AMMORTIZZATO STELO PASSANTE
DOUBLE ACTING CUSHIONED THROUGH PISTON ROD

CDEPØ/...EL

CDEMPØ/...EL

CDEAPØ/...EL

CDEMAPØ/...EL

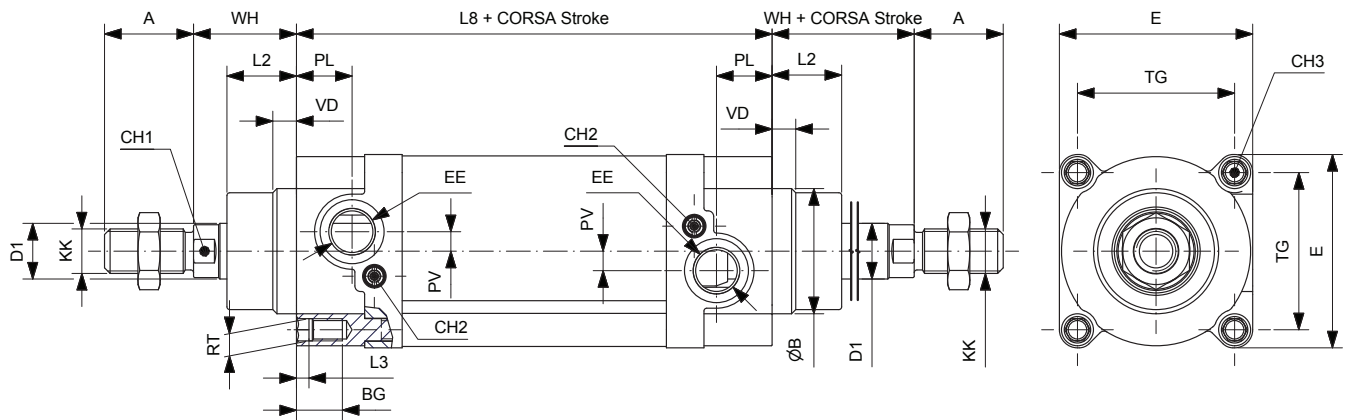

DIMENSIONI
DIMENSIONS

Ømm	ØD1	KK	A	ØB	VD	L2	RT	BG	L3	TG	EE	PL	PV	WH	L8	E	CH1	CH2	CH3
32	12	M10x1.25	22	30	8	18	M6	16.5	5	32.5	1/8"G	12.5	-	26	94	44	10	2	6
40	16	M12x1.25	24	35	12	22	M6	16.5	5	38	1/4"G	14	-	30	105	51	13	2.5	6
50	20	M16x1.5	32	40	10.5	25.5	M8	16.5	4.5	46.5	1/4"G	14	-	37	106	59.5	17	2.5	8
63	20	M16x1.5	32	45	8.5	25	M8	16.5	4.5	56.5	3/8"G	20	7	37	121	69.5	17	2.5	8
80	25	M20x1.5	40	45	10	35	M10	17	-	72	3/8"G	18.5	6.5	46	128	87	22	4	-
100	25	M20x1.5	40	55	12.5	38	M10	17	-	89	1/2"G	20	12	51	138	106.5	22	4	-

FORZE DI TRAZIONE E SPINTA (6 BAR)
TRACTION AND THRUST FORCES (6 BAR)

Ø mm	FORZA DI SPINTA (N) THRUST FORCE (N)	FORZA DI TRAZIONE (N) TRACTION FORCE (N)
32	394	394
40	601	601
50	939	939
63	1596	1596
80	2583	2583
100	4194	4194